



VPN Series

Vertical pump VPN series

www.inbeat.es

Very sturdily built vertical submerged centrifugal pumps with **column lengths of up to 4.500 mm.**

The minimum start up liquid level of the pump is 100 mm above of the pump casing.

According to customer needs, the suction prolongation pipe can be up to 3500 mm.

It allows our VPN series to reach up to 8 m of suction depth.

Under request, INBEAT produces VPN series with special arrangements according to end user technical specification, offering great flexibility and wide range of technical solutions.

The **vapour-tightness** of the column of the unit is achieved by anticorrosion seals.

DRIVES & SUPPORT BEARINGS

The bearing units are divided into 3 types according to the power required by the process, with the possibility of attaching high power motors of up to size **IEC 315**. The robustness of the support bearings ensures adequate mechanical resistance to the most demanding operations.

APPLICATIONS

VPN series are widely used in processes involving highly corrosive chemical substances.

The scope of uses of VPN series are wide-ranging: Chemical Industry, Water treatment processes such as Desalination, steel industry, environment industry, etc.

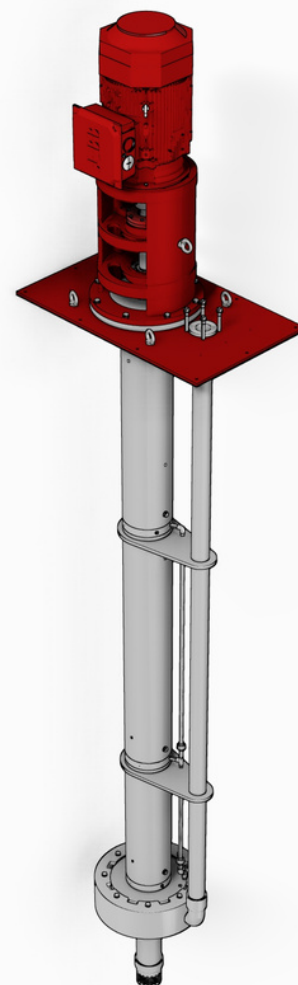

CHARACTERISTICS

- Flow rates up to 480 m³/h.
- Heights up to 100 m.c.l.
- Immersion length up to 4500 mm.
- Prolongation filter pipe from 100 mm to 3500 mm.

MATERIALS

- PP
- PEH
- PVC
- PVDF
- GRP

A. SUPPORT BEARINGS

Reliable and robust pump motor support, capable to handle drives up to IEC 315 sizes.

- Independent support bearing shaft.
- Axial and radial bearings for a heavy duty efforts support.
- Depending on assembling pump characteristics, independent removable support bearings from pump cane elements.

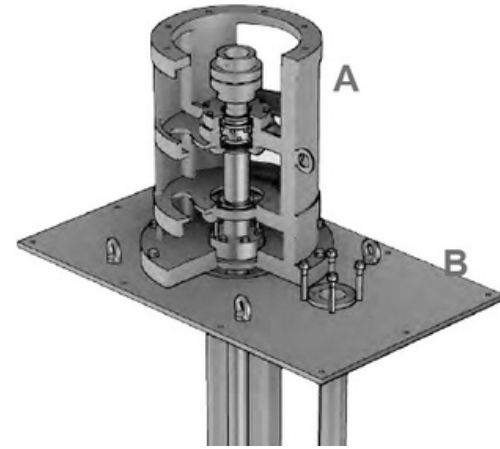

B. BASE PLATE

Special dimension design available under request.

C. SLEEVE BEARINGS FLUSHING

Several flushing arrangements: Process fluid/ External flushing.

D. SLEEVE BEARINGS

Depending on the cane length. Up to 3 sleeve bearings for a correct and stable mechanical running.

Several materials Available:

- Graphite / Special alloys

E. SHAFT PROTECTION

All wetted parts protected against corrosion. Shaft sleeve in thermoplastic material.

F. BAYONET ASSEMBLY SYSTEM

Bayonet assembly type for Pump body and casing over with anti-rotation thermoplastic screws. It avoids corrosion risk and ease the open-close maintenance operation.

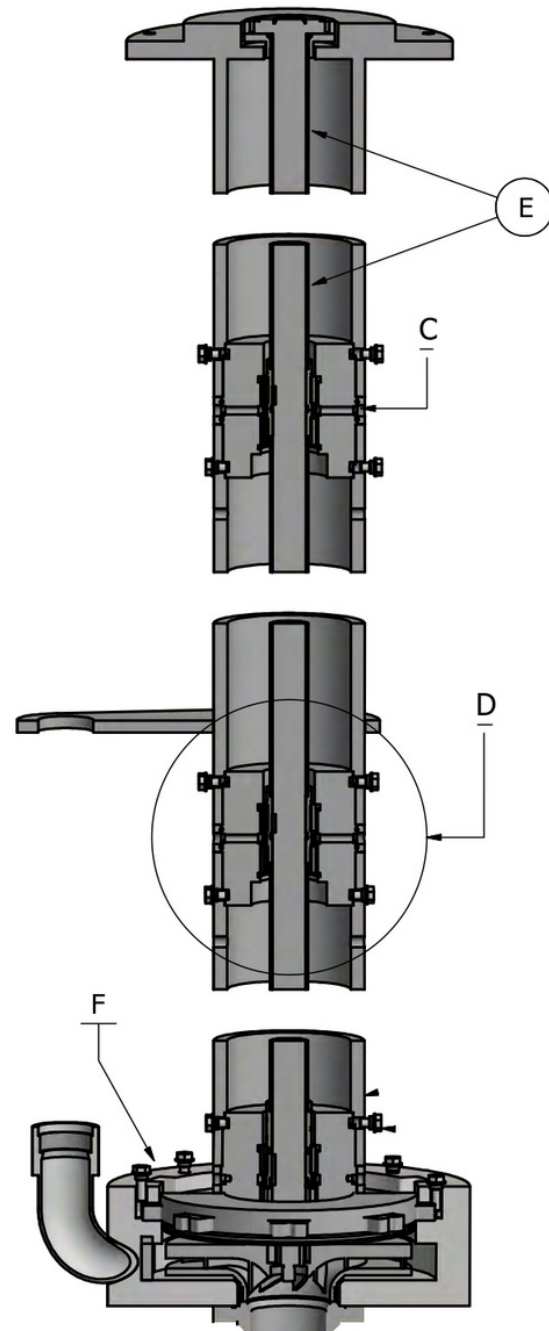

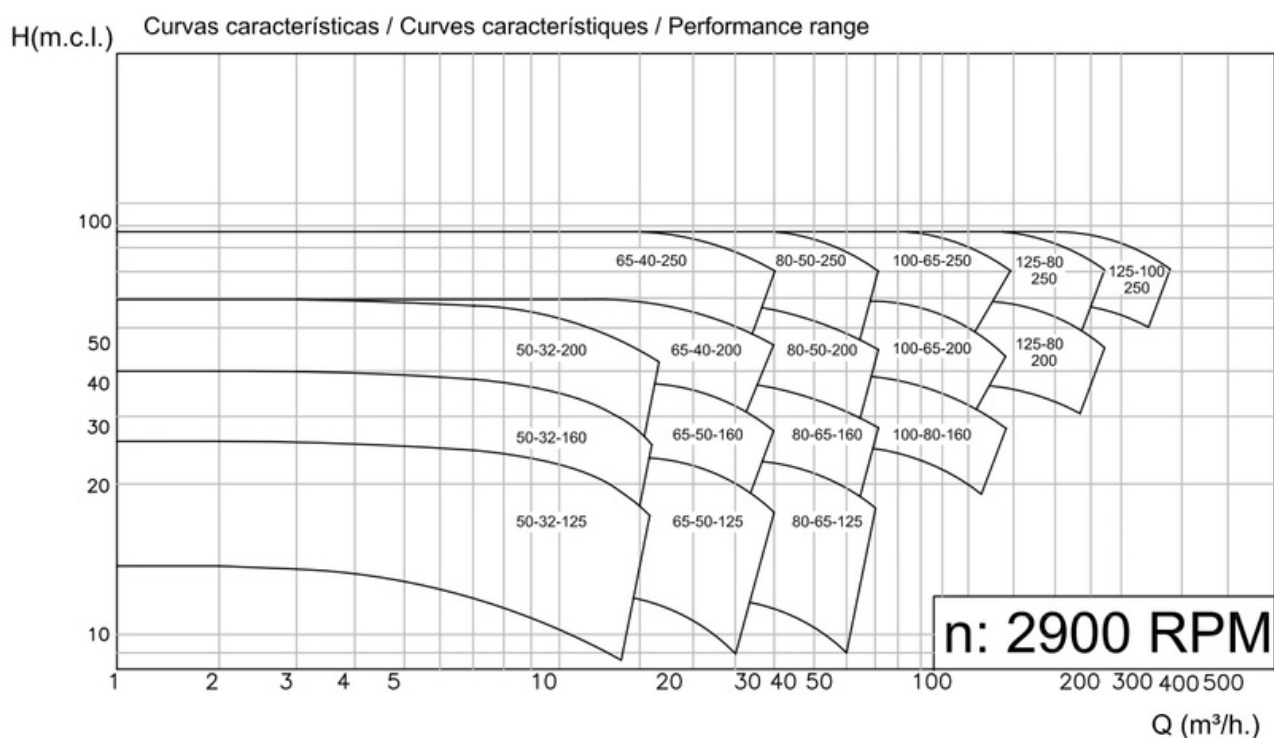
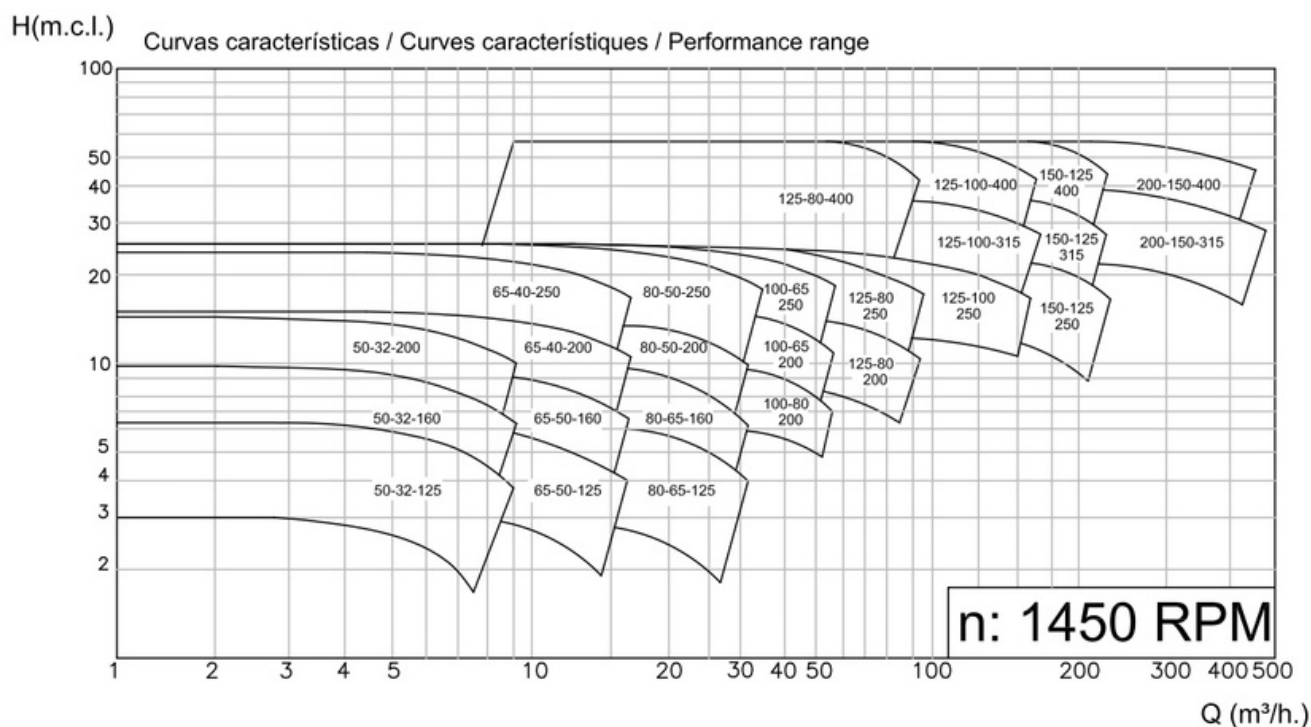

BRIDAS / FLANGES / BRIDES - ISO 7005-1 PN-16

TIPO TYPE TYPE	DN	ET	F	B max.	E	H	D	PLACA BASE BASE PLATE PLAQUE D'ASSISE
32-125	32	1000 / 1500 / 2000 / 2500 / 3000 / 3500 / 4000 / 4500 mm	SEGÚN ESPECIFICACIONES DEL USUARIO ACCORDING END USER SPECIFICATIONS SELON SPECIFICATIONS DE L'UTILISATEUR A TO JUSQU'A 100 mm	465	245	395	260	R2
32-160						413	280	R2
32-200						423	300	R2
50-125	275				460	290	R3	
50-160					465	300	R3	
50-200					502	375	R3	
50-250				515	400	R3		
50-315	960			370	645	470	R5	
80-160				320	550	350	R4	
80-200					575	400	R4	
80-250					595	440	R4	
80-315				370	660	470	R5	
80-400				675	500	R5		
100-250	100			530	863	520	R6	
100-315					883	560	R6	
100-400		650	1023		600	R7		
125-250	125	530	890	560	R6			
125-315			890	560	R6			
125-400			650	1030	600	R7		
150-250	1050	600		R7				
150-315	1050	600		R7				
150-400	1050	600		R7				
150-500	150	700	1200	700	R8			

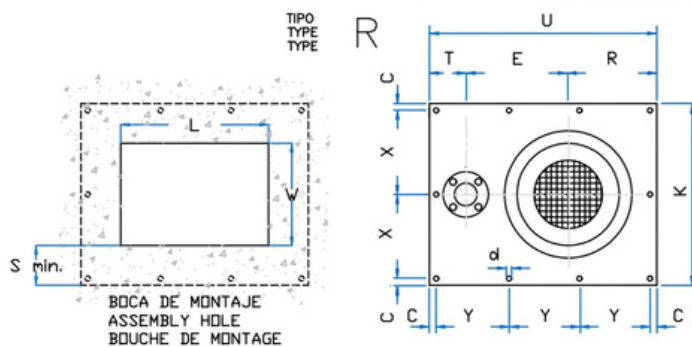
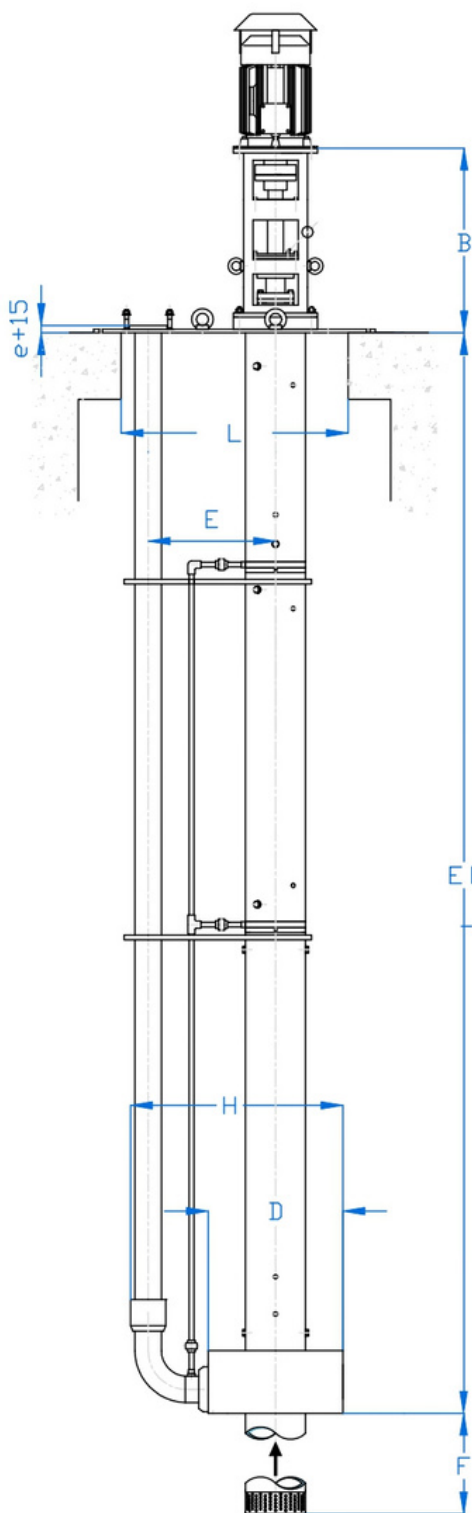

PLACA BASE / BASE PLATE / PLAQUE D'ASSISE													MONTAJE/ASSEMBLY/MONTAGE		
Nº	K	U	T	E	R	C	X	Y	d	e	L	W	Smin.		
R2	490	616	125	245	246	20	—	192	14	15	435	310	90		
R3	550	725	150	275	300	25	—	225	14	20	525	410	70		
R4	650	833	163	320	350	25	300	261	14	20	605	450	100		
R5	720	1059	230	370	459	30	330	333	14	20	685	510	105		
R6	720	1200	310	530	360	30	330	380	14	20	900	570	75		
R7	820	1300	240	650	410	30	380	310	14	20	1060	610	105		
R8	920	1400	210	700	490	30	430	335	14	20	1210	710	95		

VPN-ML



Vertical submerged centrifugal VPN-ML pumps in thermoplastic materials for small and mid-range flow rates and discharge pressures; sturdily built with column lengths of up to 1200 mm.

An extension suction tube can be attached in order to reach the total depth of the tank according customer needs.

The vapour-tightness of the column of the unit is achieved by anticorrosion seals.

ATEX 94/9/CE arrangement under request.

VPN-ML

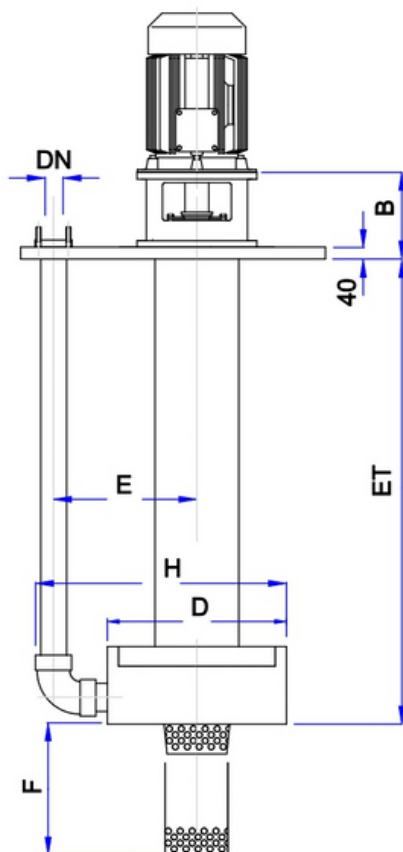

Dimensiones en / Dimensions in / Dimensions en mm.

TIPO TYPE TYPE	DN	D	F	PLACA BASE BASE PLATE PLAQUE D'ASSISE Tamaño/Size/Taille MR-1 / MC-1			
				H	B	H	B
25-115	25	225	LONGITUD OPCIONAL OPTIONAL LENGTH LONGUEUR OPTIONNEL	320	140	—	—
25-125		250		330		410	260
25-160		270		340		415	
32-125	32	250		340		410	
32-160		270		350		415	
40-115	40	250		350		415	
40-125		250		350		415	
40-160		280		365		415	
50-125	50	280		350		415	
50-160		300		—	—	425	

BRIDAS / FLANGES / BRIDES ISO 7005-1 PN-16

LONGITUDES ESTANDAR DE:
STANDARD LENGTH OF:
LONGUEURS STANDARD DE:

ET = 500, 800, 1200

MOTOR / MOTOR / MOTEUR

Tipo/Type/Type	71K	71N	80K	80N	90S	90L	100L	100L	112M	132S	132M
Kw											
a/to/at 3000 rpm	0,37	0,55	0,75	1,1	1,5	2,2	3		4	5,5	7,5
Kw											
a/to/at 1500 rpm	0,25	0,37	0,55	0,75	1,1	1,5	2,2	3	4	5,5	7,5
Placa base Base plate Plaque d'assise	MR-1 / MC-1 234						MR-2 / MC-2				

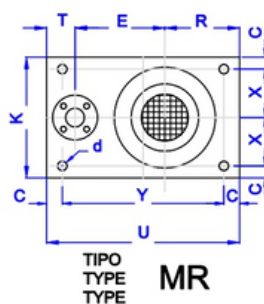

PLACA BASE / BASE PLATE / PLAQUE D'ASSISE

	MR-1	MR-2	MC-1	MC-2
K	350	400	—	—
U	445	540	445	540
T	90	95	90	95
E	180	245	180	245
R	175	200	175	200
C	22,5	22,5	—	—
X	152,5	177,5	—	—
Y	400	495	400	495
dØ	14	14	14	14
n°	4	4	6	6

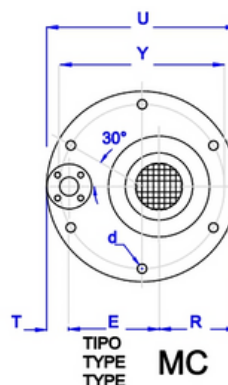

VPN-MS



Vertical submerged centrifugal VPN-MS pumps in thermoplastic materials for mid-range flow rates and discharge pressures; sturdily built with column lengths of up to 1.500 mm.

An extension suction tube can be attached in order to reach the total depth of the tank according customer needs.

The vapour-tightness of the column of the unit is achieved by anticorrosion seals.

ATEX 94/9/CE arrangement under request.

VPN-MS

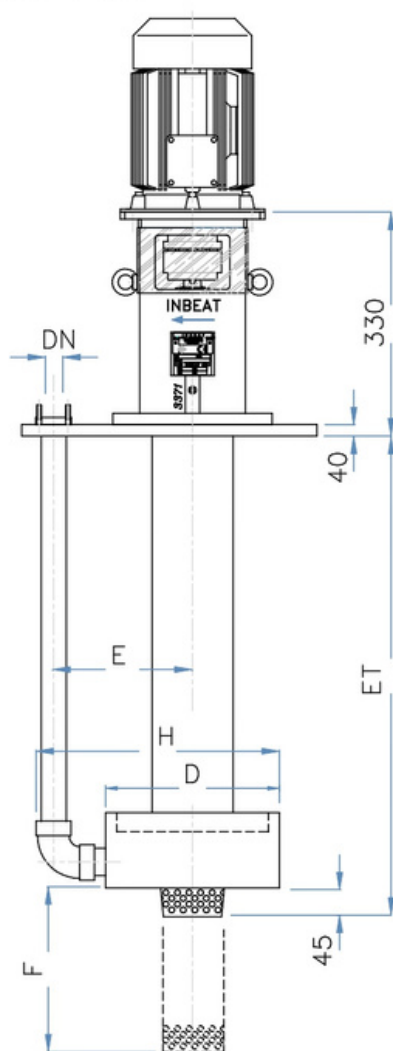

TIPO TYPE TYPE	DN	D	F	ET	H	L	W	S _{min}
25-115	25	225	LONGITUD OPCIIONAL OPTIONAL LENGTH LONGUEUR OPTIONNEL	LONGITUDES ESTANDAR DE: STANDARD LENGTH OF: LONGUEURS STANDARD DE: 500, 800, 1000, 1200, 1500	340	350	235	95
25-125		250			350	360	260	90
25-160		270			360	370	280	85
32-125	32	250			360	370	260	85
32-160		270			370	380	280	80
40-115	40	250			370	380	260	80
40-125		250			370	380	260	80
40-160		280			385	395	290	72.5
50-125	50	270			385	395	280	72.5
50-160		300			395	405	310	67.5

Dimensiones en / Dimensions in / Dimensions en: mm

BRIDAS / FLANGES / BRIDES ISO 7005-1 PN-16 - ANSI B16.5#150lbs

PLACA BASE / BASE PLATE / PLAQUE D'ASSISE

	SR	SC
K	400	—
U	540	540
T	120	120
E	200	200
R	220	220
C	22,5	—
X	177,5	—
Y	247.5x2	495
d	14	14
n*	4	8

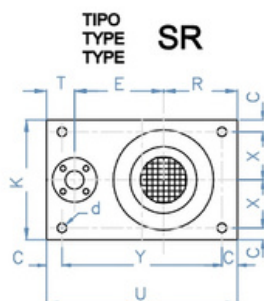
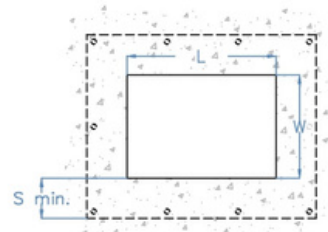

TIPO
TYPE
TYPE

SR

Bajo demanda la placa base puede ser de diferentes formas y medidas.

Other forms and dimensions base plate can be supplied if requested.

Sur demande la plaque d'assise peut être de forme et dimensions différents.

TIPO
TYPE
TYPE

SC

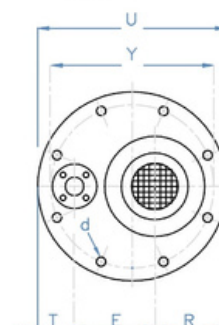

PERFORMANCE CURVES FOR THE ALTERNATIVE PUMPS TO VPN

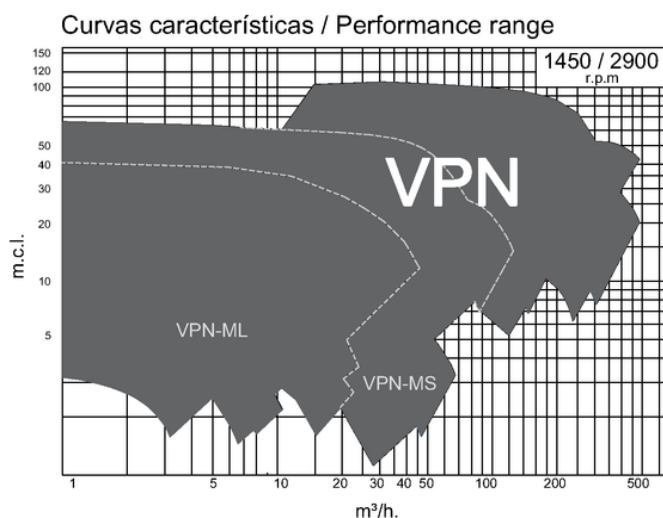

CHARACTERISTICS

- Flow rates up to **450 m³/h.**
- Heights up to **130 m.c.l.**

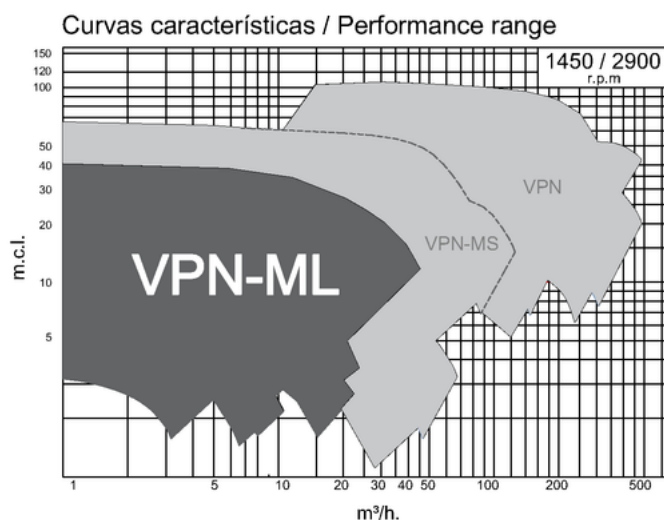

CHARACTERISTICS

- Flow rates up to **60 m³/h.**
- Heights up to **40 m.c.l.**

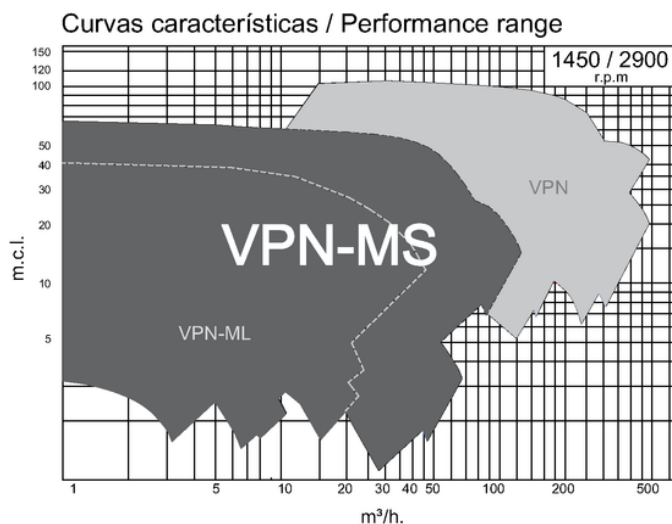

CHARACTERISTICS

- Flow rates up to **100 m³/h.**
- Heights up to **55 m.c.l.**



Júpiter, 53 - P.I. Can Parellada - 08228 Terrassa
BARCELONA
inbeat@inbeat.es
+34 93 785 25 16

www.inbeat.es