

# **PNA Series**

**Self-Priming Centrifugal pump PNA series**

Self-priming centrifugal pumps, EN-22858 and ISO-2858, give PN type units the capacity to suck to a depth of up to 3 m. with no need for foot valve.

If the process may require it, PN series units can be supplied with a priming tank, making the unit self-priming at higher suction heights depending on the characteristics of the process.

The shaft sealing systems meet the needs of the process with the possibility of installing a wide range of market seals, either single, double opposition or external well balanced.

#### CHARACTERISTICS

- Flow rates up to 100 m<sup>3</sup>/h.
- Heights up to 60 m.c.l.

#### MATERIALS

- All wetted parts are made with anti corrosive materials such as:
  - PP
  - PEH
  - PVC
  - PVDF
  - PTFE

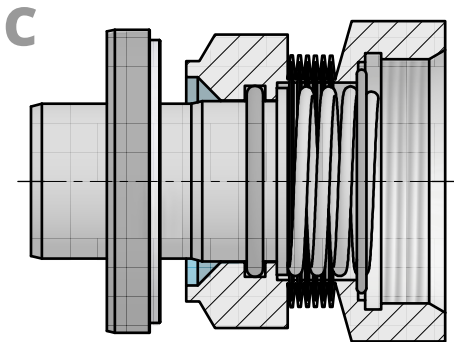

**awL**

**C tCwaL**

**D**

**CtatatCCCa**

OPEkAuION LIMluS

† 44 /

P a

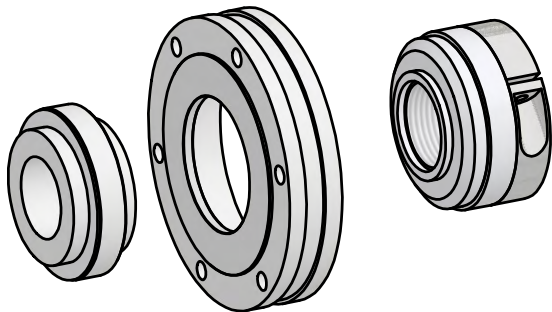
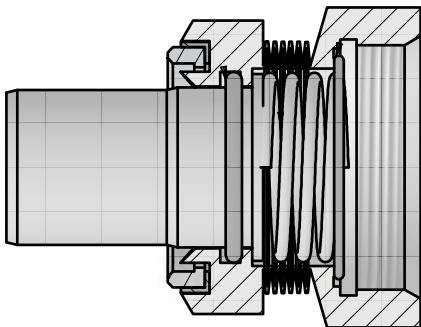
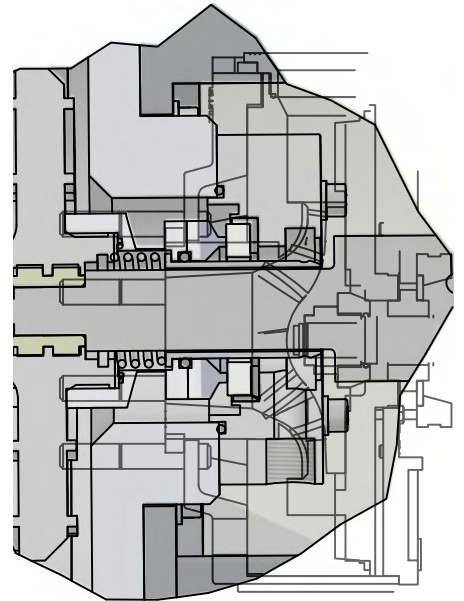

MAuEkIALES

-PuFE † /CEkAMIC -SSiC/SSiC

GASMEuS

-FPM/EPDM/PuFE

OPEkAuION LIMluS

† / - P a

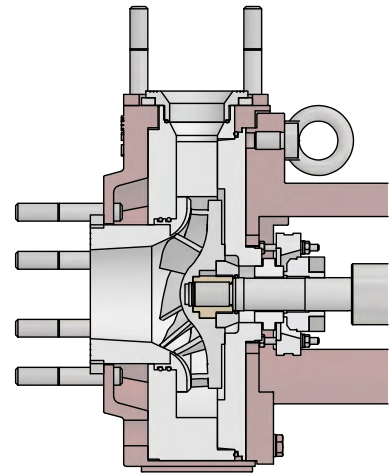

**. Lb ttLLb**

- API plan 53/54 FLUSHING

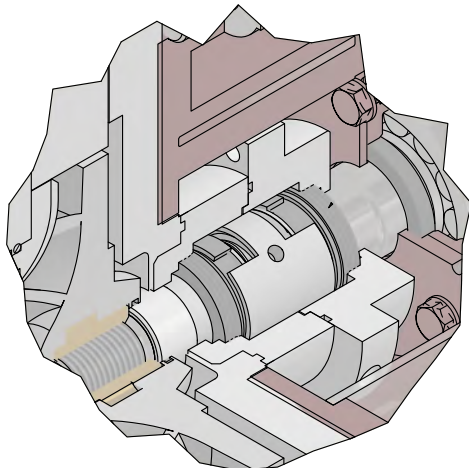

MAuEkIALES, SSiC/SSiC

GASMEuS FPM/EPDM

OPEkAuION LIMluS

† 5 /

P a

u Up C

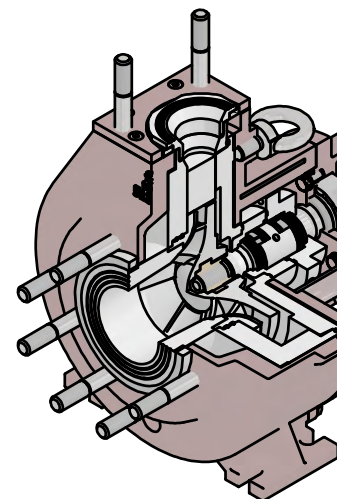

**m.c.l.** Curvas características / Performance range

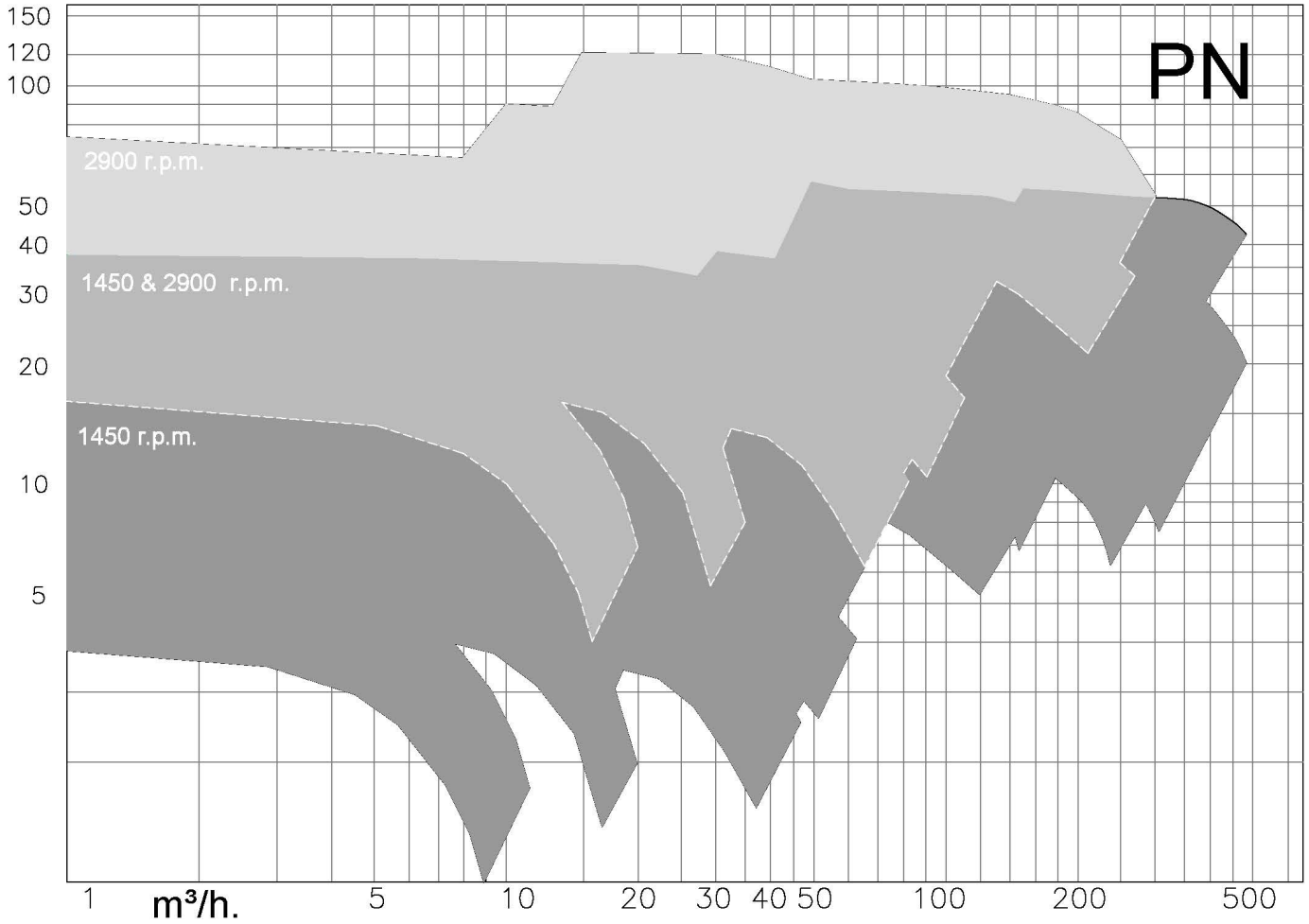





Júpiter, 53 - P.I. Can Parellada - 08228 Terrassa  
BARCELONA  
inbeat@inbeat.es  
+34 93 785 25 16

[www.inbeat.es](http://www.inbeat.es)