

MPNC Series

Horizontal pumps MPNC series

GENERAL CHARACTERISTICS

Single stage, monobloc pump, for discharging ACIDS, ALKALIS and CHEMICAL EFFLUENTS.

The casing safety chamber by these units can be an added value in discharge processes, since in the event of depletion of the tank to be discharged the pump chamber conveys the liquid remaining in the pump chamber for a maximum of 7 minutes. This gives enough time to stop the unit and thereby prevent the damage typical of dry operation.

The shaft sealing systems meet the needs of the process with the possibility of installing a wide range of market seals, either single, double opposition or external well balanced.

APPLICATIONS

These anticorrosive close-coupled pump version pumps for a wide range of industrial processes. Their reliability and flexibility make them ideal for frequently used small and medium sized facilities.

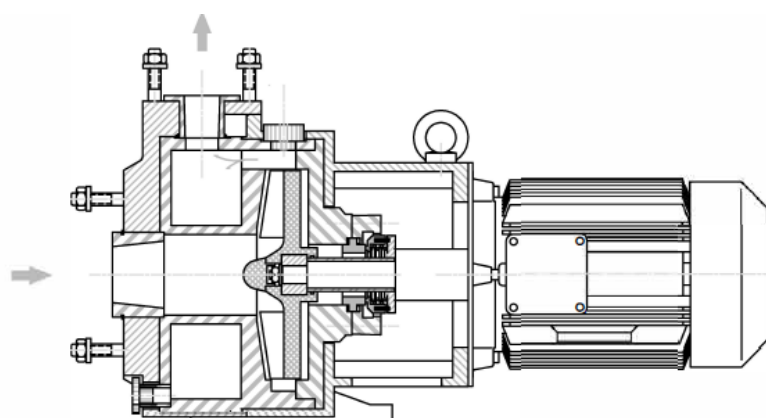

CHARACTERISTICS

- Flow up to 40 m³/h.
- Head up to 35mt.

MATERIALS

- PP
- PEH
- PVC
- PVDF

Type **SF**

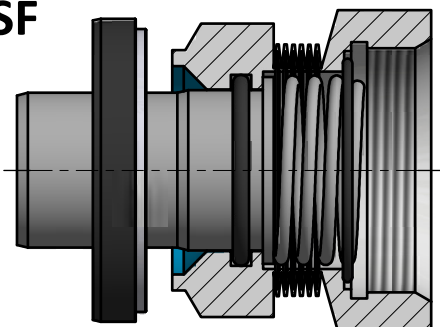

Type **SC**

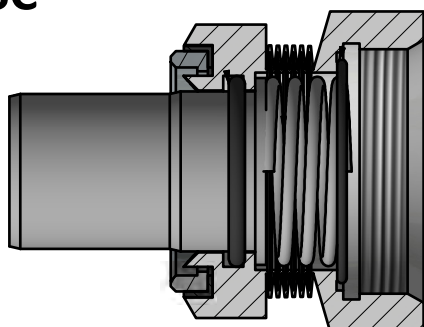

MATERIALS

-SF: PTFE+Vx1/CERAMIC

-SC: SSiC/SSiC

GASKETS:

-FPM/EPDM/PTFE/FFKM

OPERATION LIMITS:

V=8,44 m/s

P= 6 bar

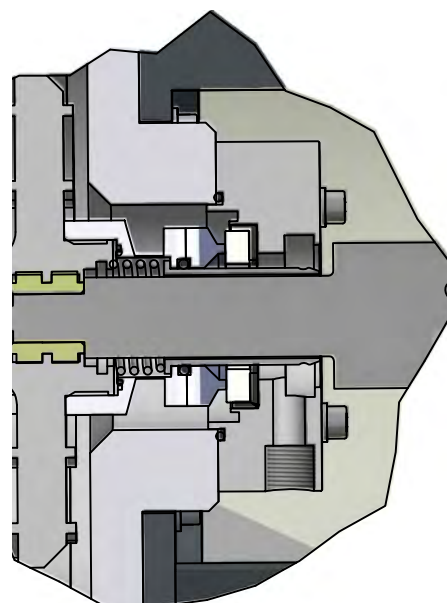

Tipo **SE**

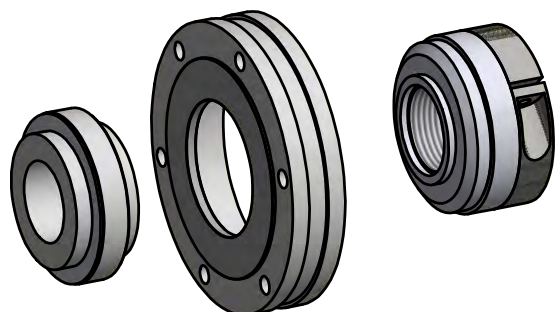

MATERIALES

-PTFE+Vx1/CERAMIC -SSiC/SSiC

GASKETS:

-FPM/EPDM/PTFE

OPERATION LIMITS:

V=8 m/s - P= 9 bar

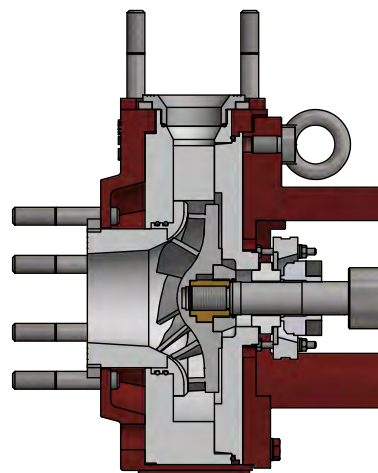

Type **8622** DOUBLE IN OPPOSITION - API plan 53/54 FLUSHING

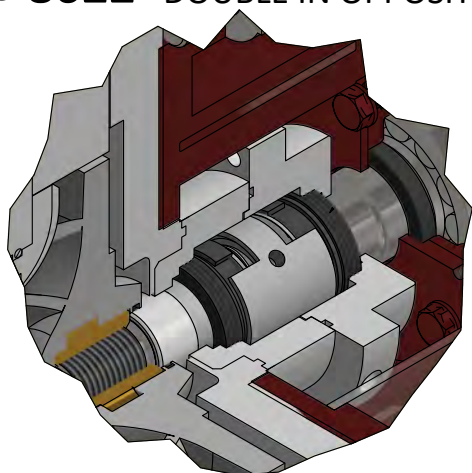

MATERIALES : SSiC/SSiC

GASKETS: FPM/EPDM

OPERATION LIMITS:

V=25 m/s

P= 10 bar

T= Up to 200°C

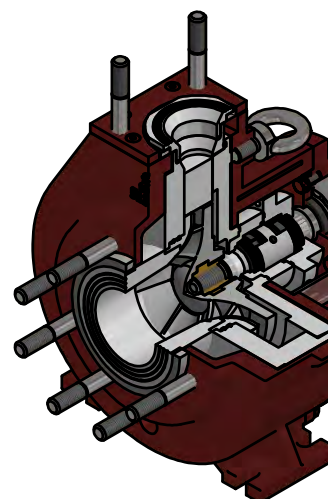

CURVAS CARACTERISTICAS / PERFORMANCE RANGE / PERFORMANCES

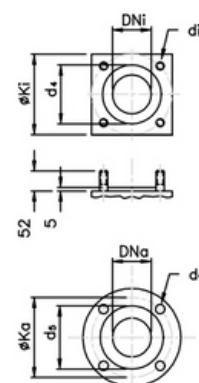
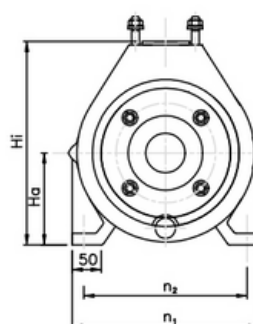
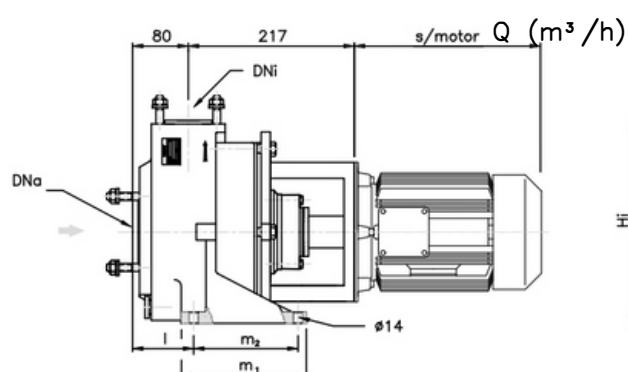
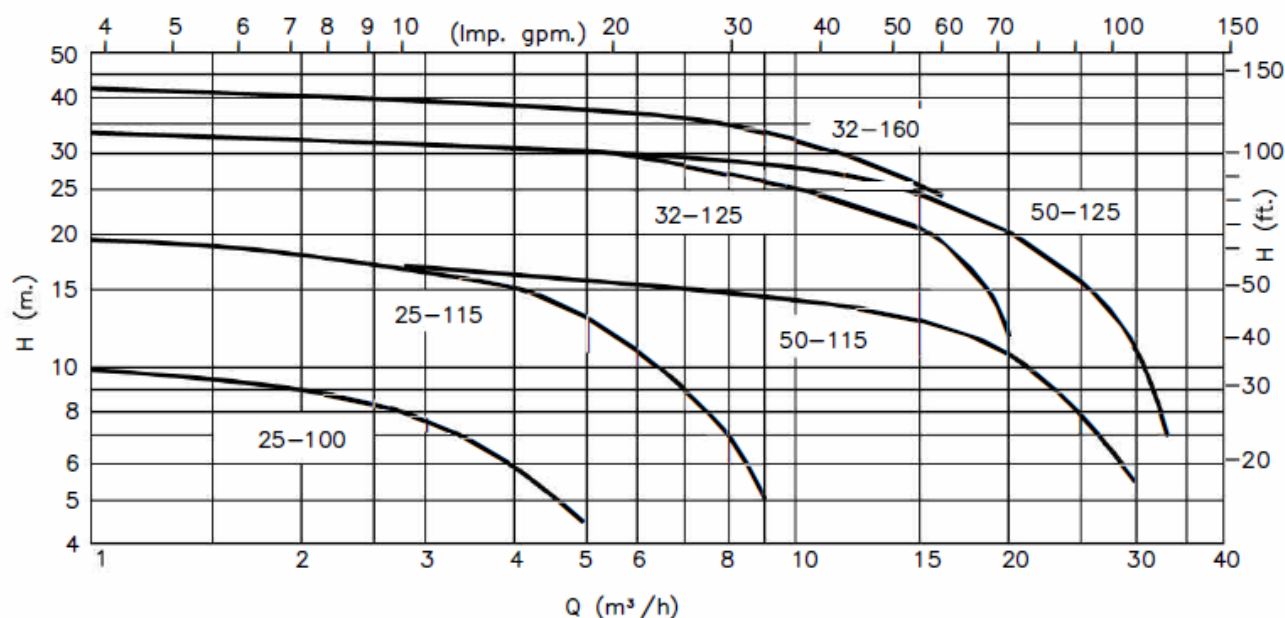

BOMBA / PUMP / POMPE

TIPO TYPE	BRIDAS FLANGES BRIDES		DIMENSIONES DIMENSIONS														n.º n.º
	ISO 7005-1 DNa	PN-16 DNi	Ha	Hi	l	m ₁	m ₂	n ₁	n ₂	Ka	Ki	da	di	d ₅	d ₄		
25-100	40	25	112	237	80	160	124	210	164	110	85		M-12	92	68	4	
25-115																	M-16
50-115	65	50								145	125	122	98				
32-125	50	32						125	100					92	68		
50-125	65	50								145	125	122	98				
32-160	50	32		265				212	125					100	92		68



Júpiter, 53 - P.I. Can Parellada - 08228 Terrassa
BARCELONA
inbeat@inbeat.es
+34 93 785 25 16

www.inbeat.es