



# **MPN Series**

**Horizontal close-coupled centrifugal  
pump MPN series**

Anticorrosive pumps monobloc version for a wide range of industrial processes. Its reliability and flexibility make them ideal for small/median installations frequently used. The constructive execution of the pump allows disassembly for repair operations maintenance without changing the location of the support-body assembly of the pump (pos 01-03-31).

The shaft sealing systems adapt to the needs of the process, being able to install a wide range of market closures, whether simple, double in opposition and balanced exteriors.

The MPN series has a wide range of highly corrosive chemical related applications; Its use being common in small/medium scrubbers, lines of loading and recirculation of reagents covering the needs of the current industry in fields such as desalination, metallurgy and environmental industries.

**ATEX 94/9/CE executions on request according to specifications.**

### Sealing systems

The sealing systems cover the process needs with the possibility of installing a wide selection of market closures according to technical specification needs. All the parts in contact with the process fluid are made of anticorrosive material, so there are no metallic parts in contact with the fluid.

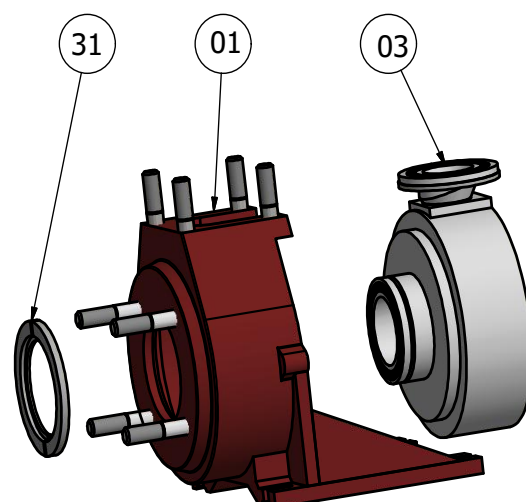

#### CHARACTERISTICS

- Flow rates up to 50 m<sup>3</sup>/h.
- Heights up to 50 m.c.l.

#### MATERIALS

- PP
- PEH
- PVC
- PVDF
- PTFE

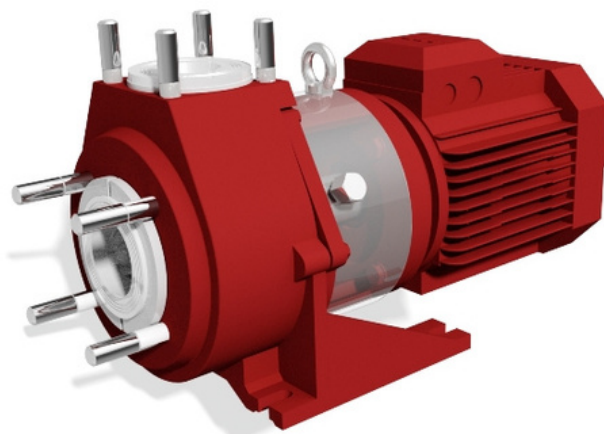

Type **SF**

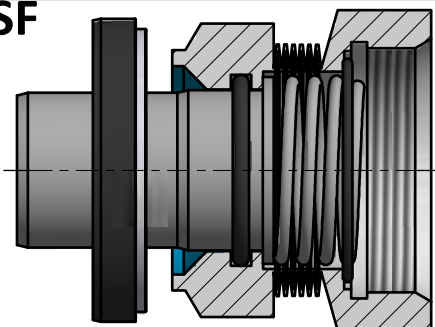

### MATERIALS

-SF: PTFE+Vx1/CERAMIC

-SC: SSiC/SSiC

GASKETS:

-FPM/EPDM/PTFE/FFKM

### OPERATION LIMITS:

V=8,44 m/s

P= 6 bar

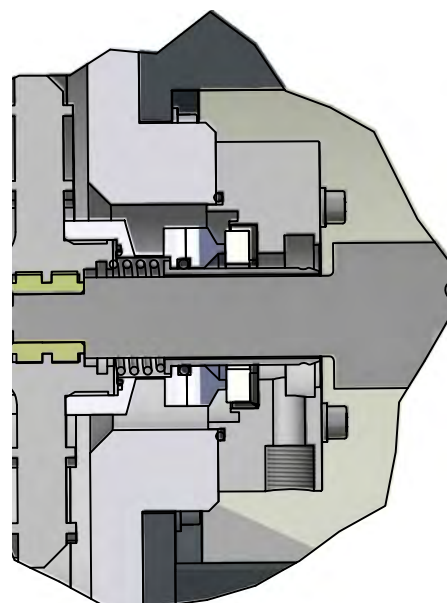

Type **SC**

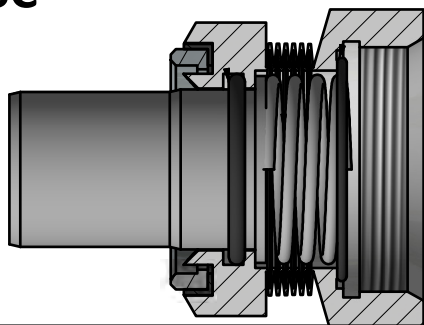

Tipo **SE**

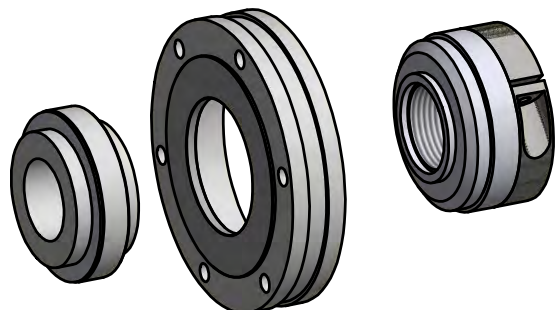

### MATERIALES

-PTFE+Vx1/CERAMIC -SSiC/SSiC

GASKETS:

-FPM/EPDM/PTFE

### OPERATION LIMITS:

V=8 m/s - P= 9 bar

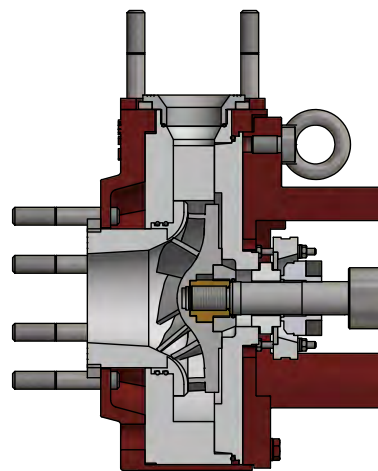

Type **8622** DOUBLE IN OPPOSITION - API plan 53/54 FLUSHING

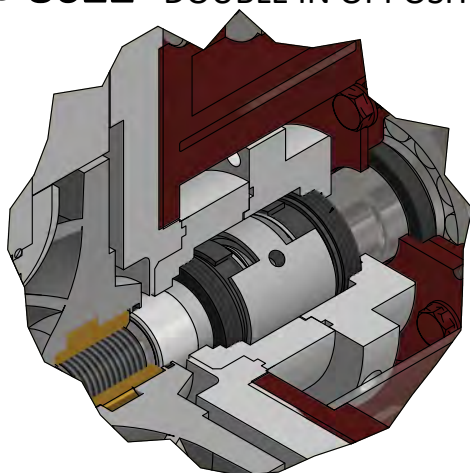

**MATERIALES :** SSiC/SSiC

GASKETS: FPM/EPDM

### OPERATION LIMITS:

V=25 m/s

P= 10 bar

T= Up to 200°C

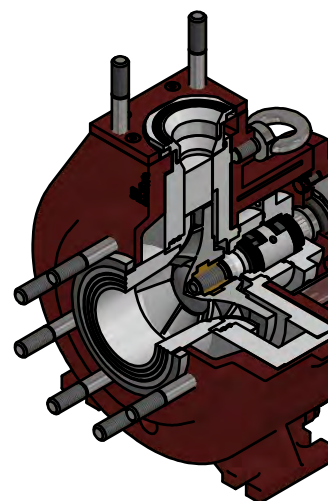

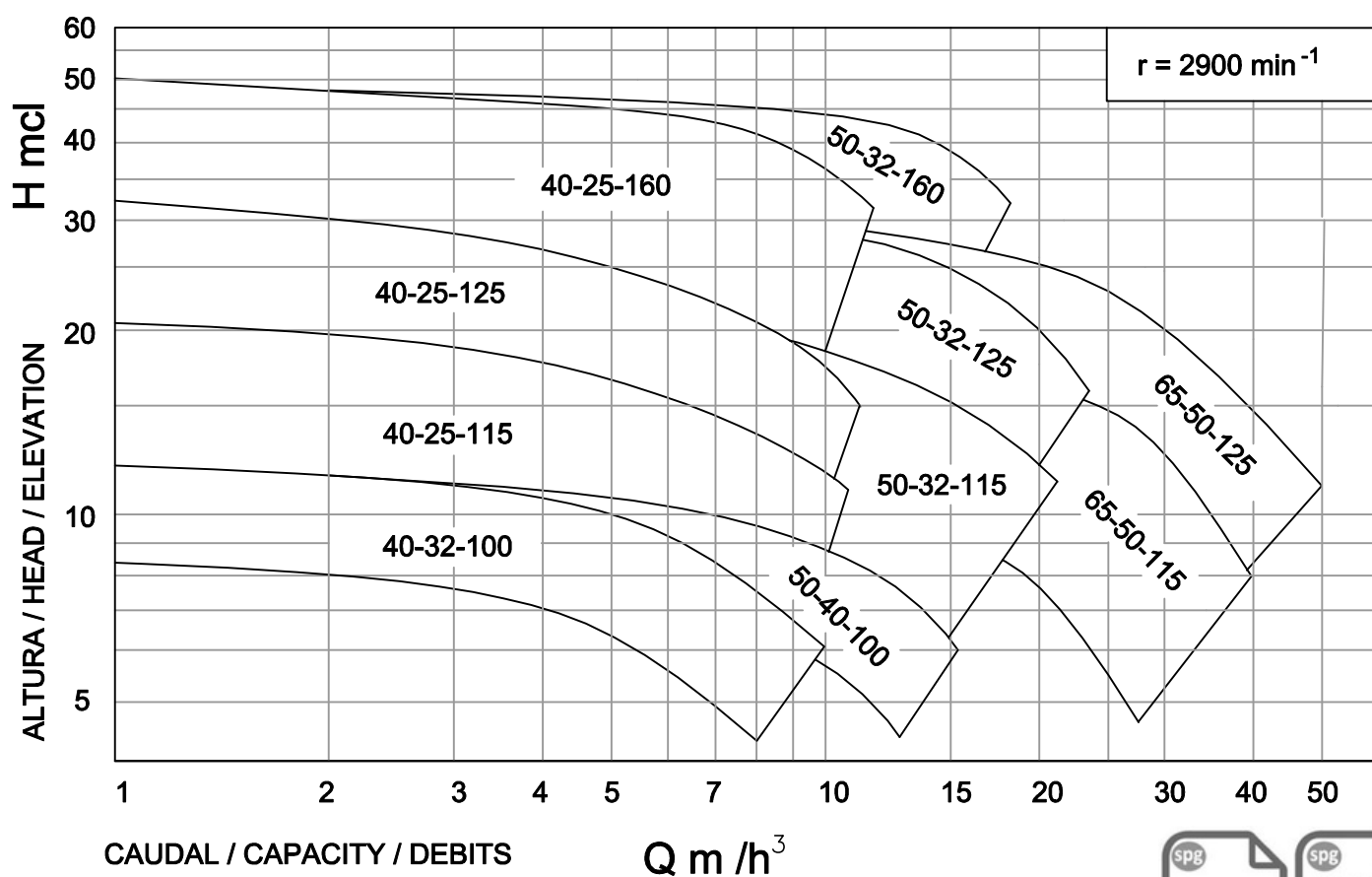
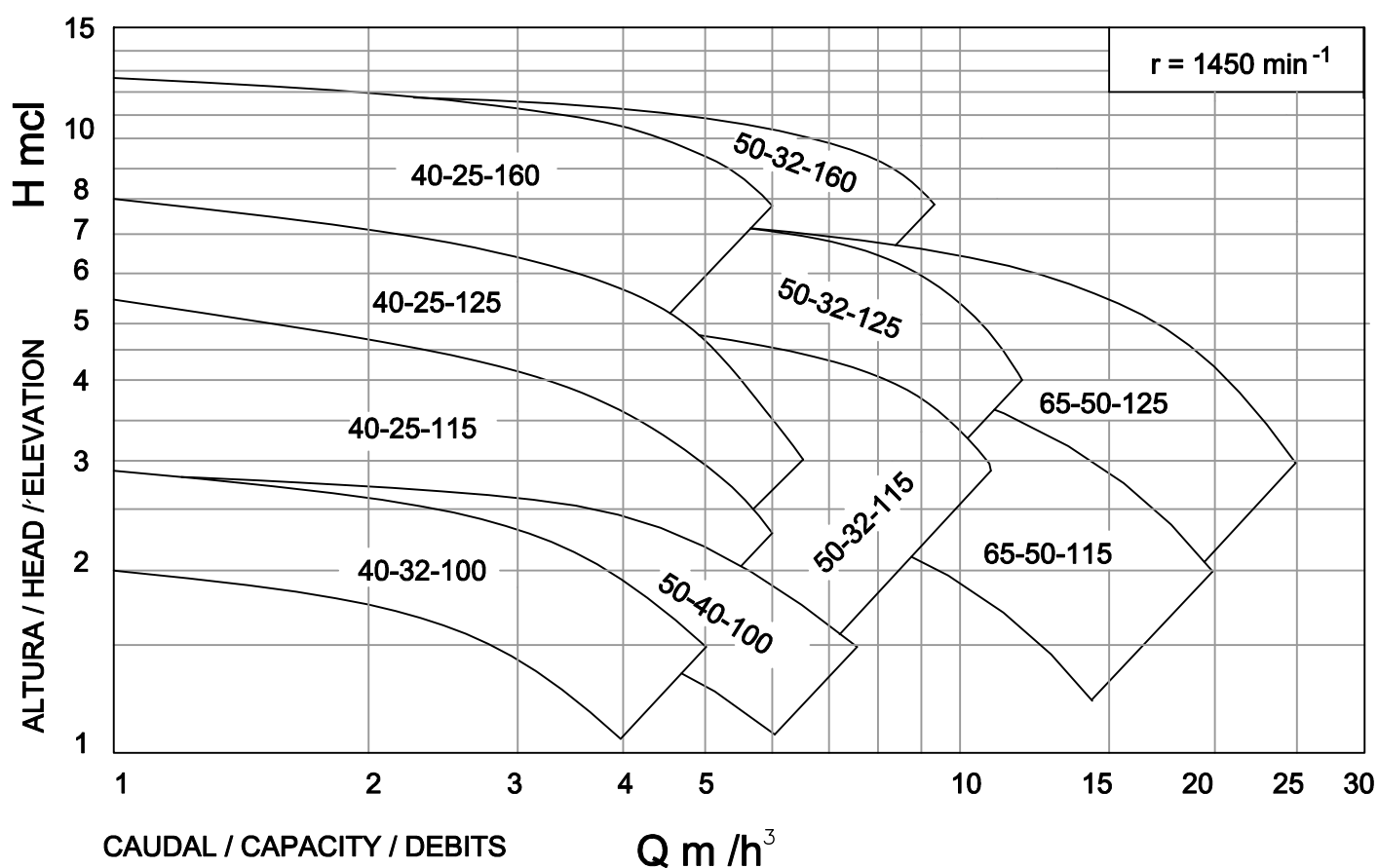

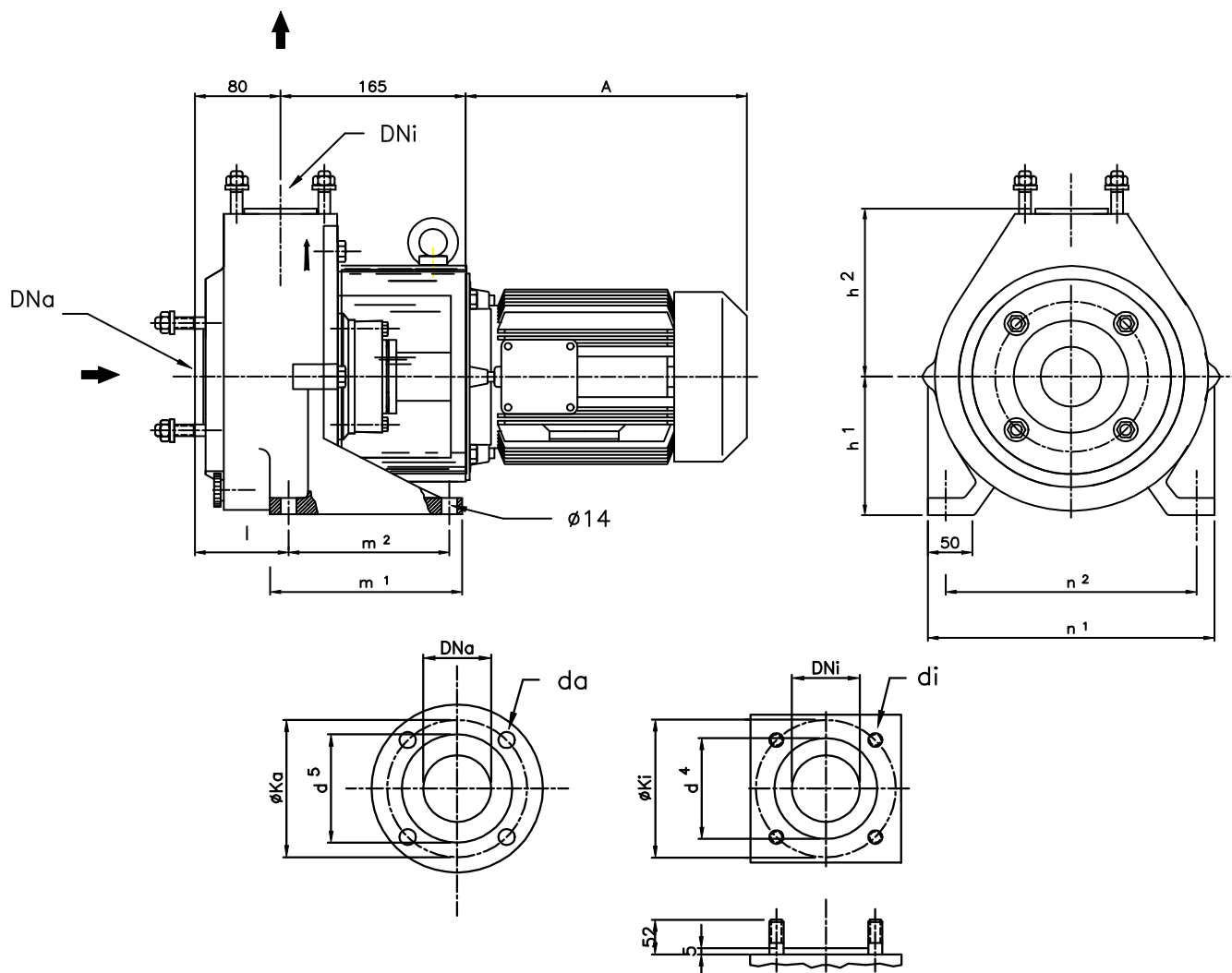

Dimensiones en mm. / Dimensions in mm. / Dimensions en mm.

### BOMBA / PUMP / POMPE

TIPO TYPE  MPN	BRIDAS FLANGES BRIDES  ISO 7005-1 PN-16 DNa   DNi		DIMENSIONES DIMENSIONS														nGo ngi
	h <sub>1</sub>	h <sub>2</sub>	l	m <sub>1</sub>	m <sub>2</sub>	n <sub>1</sub>	n <sub>2</sub>	Ka	Ki	da	di	d <sub>5</sub>	d <sub>4</sub>				
40-32-100	40	32	112	125	80	160	124	210	164	110	100	M-16	M-16	92	68	4	
50-40-100	50	40								125	110		M-12				
40-25-115	40	25								110	85		M-12				
40-25-125	40	25	132	140	90	180	140	240	190	110	85	M-16	M-12	92	68	4	
50-32-115	50	32								125	100		M-16				
50-32-125	50	32								125	100		M-16				
65-50-115	65	50								145	125		M-16				
65-50-125	65	50								145	125		M-16				
40-25-160	40	25	132	160	90	180	140	265	212	110	85	M-16	M-12	92	68	4	
50-32-160	50	32								125	100		M-16				

### MOTOR / MOTEUR

MOTOR ELECTRICO NORMALIZADO  
STANDARDIZED ELECTRIC MOTOR

MOTEUR ÉLECTRIQUE NORMALISÉ

TIPO/TYPE	71		80		90		100		112	
KW. 3000 rpm.	0.37	0.55	0.75	1.1	1.5	2.2	3		4	5.5 No estándar Non standard
KW. 1500 rpm.	0.25	0.37	0.55	0.75	1.1	1.5	2.2	3		
A*	208		234		260		295		315	

\* Datos aprox. según fabricante / Approx. data according manufacturer



Júpiter, 53 - P.I. Can Parellada - 08228 Terrassa  
BARCELONA  
inbeat@inbeat.es  
+34 93 785 25 16

[www.inbeat.es](http://www.inbeat.es)